

Building Sketch

Borrower	N/A			
Property Address	1017 Rose Angel Cir			
City	Wake Forest	County Granville	State NC	Zip Code 27587
Lender/Client	N/A			

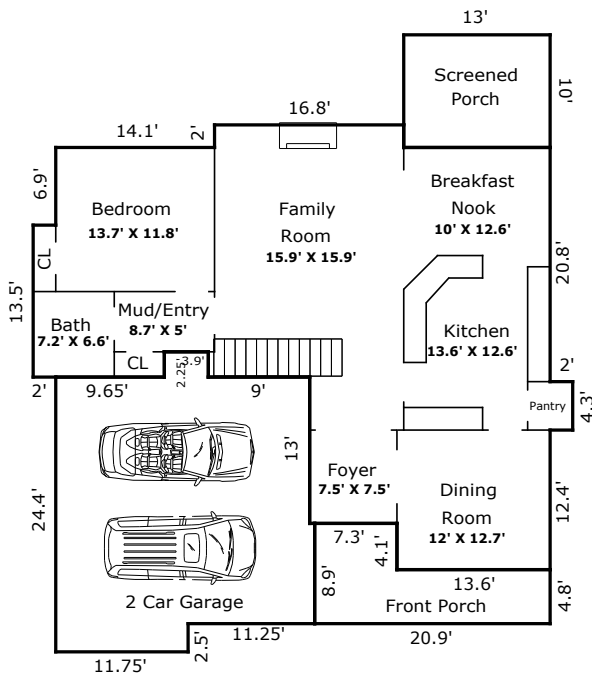

****Unfinished Walk-up Attic Approx. 43.9' X 19.5' or 856 SF*****

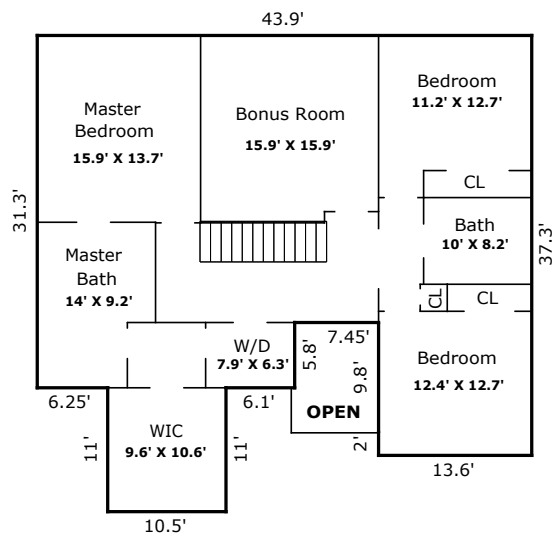

TOTAL Sketch by a la mode, inc.

Area Calculations Summary

Living Area	Calculation Details	
First Floor	1289.3 Sq ft	
		16.8 × 2 = 33.6
		4.3 × 2 = 8.6
		37.5 × 13.6 = 510
		7.75 × 13 = 100.75
		20.4 × 16.75 = 341.7
		13.55 × 6.9 = 93.5
		13.5 × 11.65 = 157.28
		3.9 × 11.25 = 43.88
Second Floor	1527.96 Sq ft	
		10.5 × 11 = 115.5
		13.6 × 11.8 = 160.48
		25.5 × 21.05 = 536.78
		22.85 × 31.3 = 715.2
Total Living Area (Rounded):	2817 Sq ft	
Non-living Area		
Covered Porch	130.25 Sq ft	8.9 × 7.3 = 64.97
		13.6 × 4.8 = 65.28
Screened Porch	130 Sq ft	13 × 10 = 130
2 Car Attached	536 Sq ft	3.9 × 2.25 = 8.78
		22.55 × 13 = 293.15
		11.4 × 11.75 = 133.95
		8.9 × 11.25 = 100.12