

Improvement Permit

A building permit cannot be issued with only an Improvement Permit

ISSUED TO: KEW STEARMAN
 NEW REPAIR EXPANSION
 Type of Structure: SFD
 Proposed Wastewater System Type: 25% REDUCTION
 Projected Daily Flow: 240 GPD
 Number of bedrooms: 2 Number of Occupants: 4 max
 Basement Yes No
 Pump Required: Yes No May be required based on final location and elevations of facilities
 Type of Water Supply: Community Public Well Distance from well _____ feet
 Permit conditions: _____

PROPERTY LOCATION: 21418 ROAD RD
 SUBDIVISION: Captains Landing LOT # 38R
 Site Improvements required prior to Construction Authorization Issuance: _____

Permit valid for: Five years
 No expiration

Authorized State Agent: James E. Markham Date: 8-21-15 SEE ATTACHED SITE SKETCH
 The issuance of this permit by the Health Department in no way guarantees the issuance of other permits. The permit holder is responsible for checking with appropriate governing bodies in meeting their requirements. This site is subject to revocation if the site plan, plat, or the intended use changes. The Improvement Permit shall not be affected by a change in ownership of the site. This permit is subject to compliance with the provisions of the Laws and Rules for Sewage Treatment and Disposal and to conditions of this permit.

Construction Authorization

(Required for Building Permit)

The construction and installation requirements of Rules .1950, .1952, .1954, .1955, .1956, .1957, .1958, and .1959 are incorporated by references into this permit and shall be met. Systems shall be installed in accordance with the attached system layout.

ISSUED TO: KEW STEARMAN PROPERTY LOCATION: 21418 ROAD RD
 SUBDIVISION: Captains Landing LOT # 38R
 Facility Type: SFD New Expansion Repair
 Basement? Yes No Basement Fixtures? Yes No
 Type of Wastewater System** Pump to 25% REDUCTION System (Initial) Wastewater Flow: 240 GPD
 (See note below, if applicable) Pump to 25% REDUCTION (Repair)

Installation Requirements/Conditions

Septic Tank Size 1000 gallons
 Pump Tank Size 1000 gallons

Number of trenches 1
 Exact length of each trench 200 feet
 Trenches shall be installed on contour at a
 Maximum Trench Depth of: 30" inches
 (Trench bottoms shall be level to +/-1/4"
 in all directions)

Trench Spacing: 9 Feet on Center
 Soil Cover: 2 inches
 (Maximum soil cover shall not exceed
 36" above the trench bottom)

Pump Requirements: _____ ft. TDH vs. _____ GPM

Aggregate Depth: 6 inches below pipe
2 inches above pipe
12 inches total

Conditions: _____

**WATER LINES (INCLUDING IRRIGATION) MUST BE 10FT. FROM ANY PART OF SEPTIC SYSTEM OR REPAIR AREA.
 NO UTILITIES ALLOWED IN INITIAL OR REPAIR DRAIN FIELD AREA.**

**If applicable: I understand the system type specified is different from the type specified on the application. I accept the specifications of this permit.

Owner/Legal Representative Signature: _____ Date: _____

This Construction Authorization is subject to revocation if the site plan, plat, or the intended use changes. The Construction Authorization shall not be transferred when there is a change in ownership of the site. This Construction Authorization is subject to compliance with the provisions of the Laws and Rules for Sewage Treatment and Disposal and to the conditions of this permit. SEE ATTACHED SITE SKETCH

Authorized State Agent: James E. Markham Date: 8-21-15
 Construction Authorization Expiration Date: 8-21-20

Environment, Health and Natural Resources
 Environmental Health
 Wastewater Section

SOIL/SITE EVALUATION for ON-SITE WASTEWATER SYSTEM

Sheet:
 Property ID:
 Lot #:
 File #:
 Code:

Applicant: S. B. [Signature]

Date Evaluated:

Design Flow (.1949): 240

Property Recorded:

Property Size:

Proposed Facility: SKP
 Location of Site:
 Water Supply:
 Evaluation Method: Auger Boring
 Type of Wastewater:

- Public Individual Well Spring Other
 Pit Cut
 Sewage Industrial Process Mixed

P R O F I L E #	.1940 Landscape Position/ Slope %	Horizon Depth (In.)	SOIL MORPHOLOGY .1941		OTHER PROFILE FACTORS				Profile Class & LTAR
			.1941 Structure/ Texture	.1941 Consistence Mineralogy	.1942 Soil Wetness/ Color	.1943 Soil Depth (IN.)	.1956 Sapro Class	.1944 Restr Horiz	
<u>1, 2, 3 4</u>	<u>N 562 L-</u>	<u>0-8</u>	<u>SL</u>	<u>FA 620 MP</u>					
		<u>8-48</u>	<u>SL-CLAY</u>	<u>FA 120 MP</u>	<u>42-44</u>	<u>52</u>			<u>.3</u>

Description: Initial System Repair System Other Factors (.1946):
 Site Classification (.1948): 35
 Evaluated By: [Signature]

HTE# 15-5-36751R

Permit # 28488

Harnett County Department of Public Health Site Sketch

ISSUED TO: KEN STEAZMAN PROPERTY LOCATION: ON 1418 RIVER RD
SUBDIVISION: Captains Landing LOT # 382

Authorized State Agent: James E. Manhart Date: 8-21-15

* Supply Line Pumped to Highest Points

* NO WATER LENS WITHIN 10' of System or Repair Area

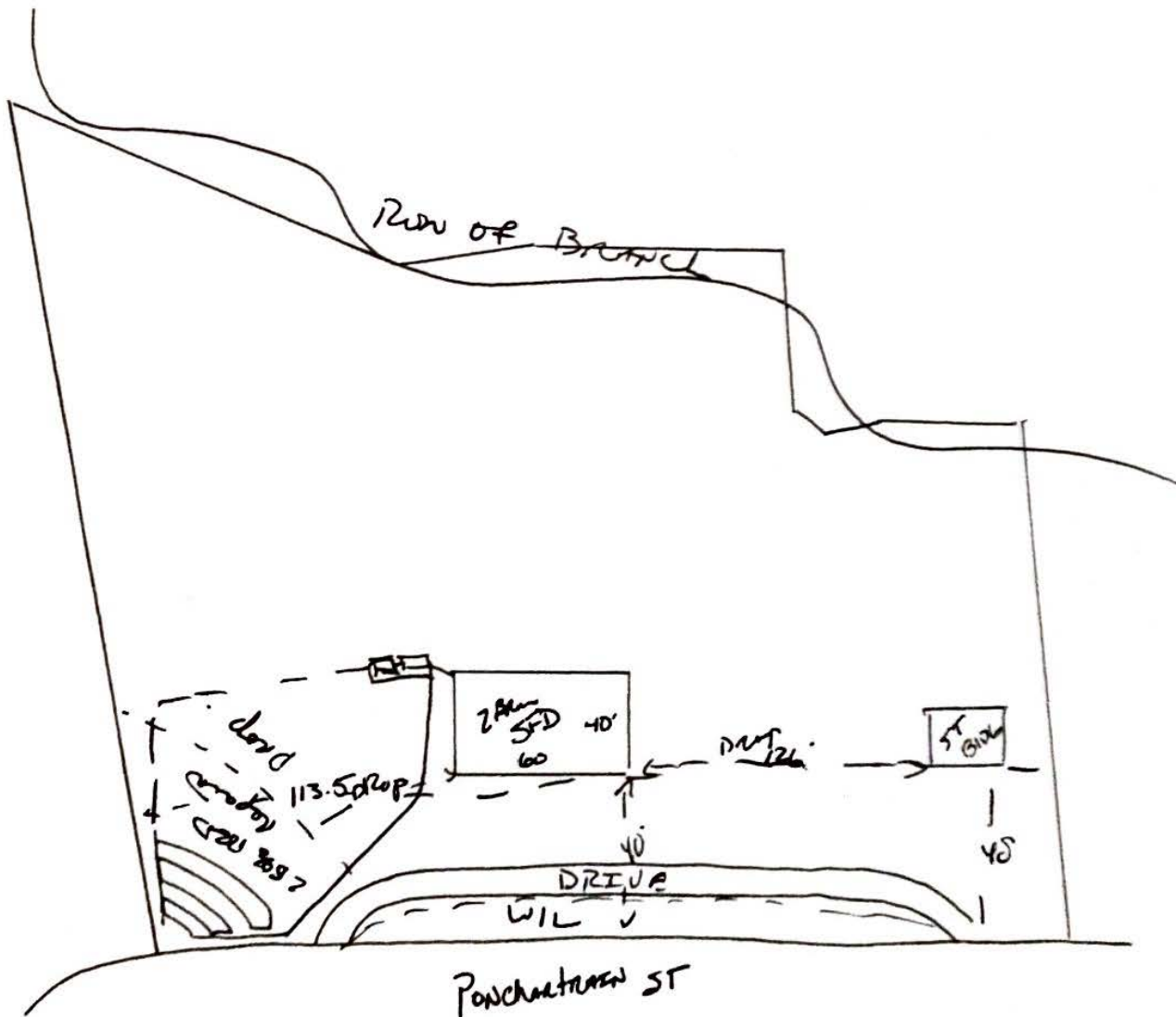



262

258

254

222

252

PONDHARTAIN

248

242

238

230

236

234